

This diagram shows how different property areas are identified for assessment.

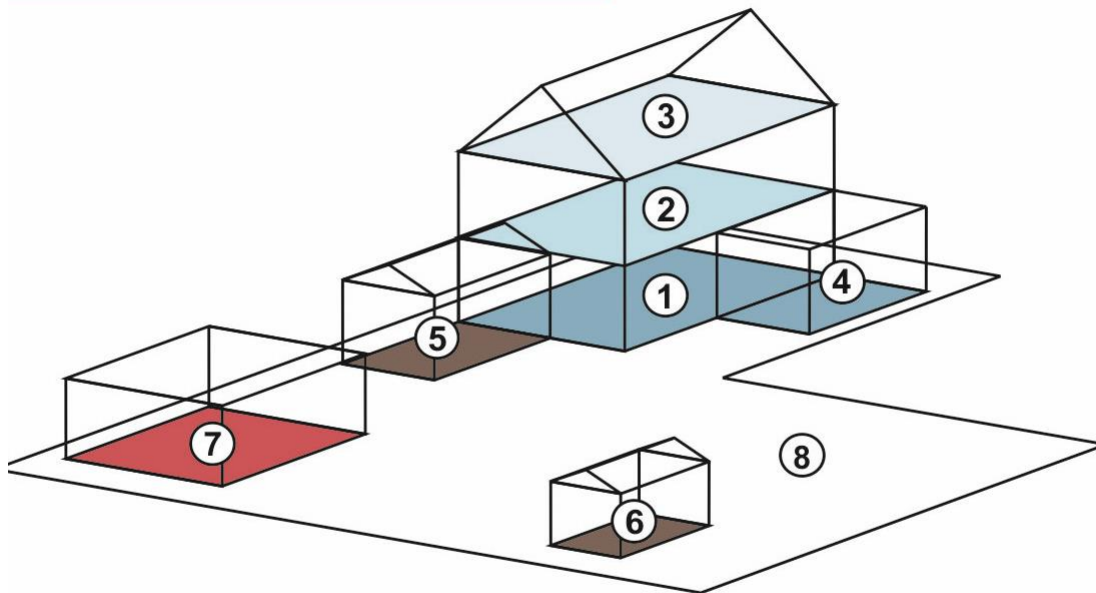

The table below shows how the unit values for the various property elements are calculated

Illustration based on 2020 combined Occupier's Rate and TRP tariff.

No.	Description	Area Sq.M	Stories No	Total Units	Tariff 2020 £	Bill 2020 £
8	Domestic (Ground floor)	50	1	50	3.24	162.00
2.	Domestic (First floor)	50	1	50	3.24	162.00
3.	Domestic (Top floor*)	50	0.5	25	3.24	81.00
4.	Domestic (Extension)	20	1	20	3.24	64.80
5.	Domestic (Extension)	15	1	15	3.24	48.60
6.	Domestic (Glasshouse)	4	1	4	0.75	3.00
7.	Domestic (Outbuilding)	25	1	25	1.63	40.75
8.	Land	Exempt	N/A	N/A	N/A	
	Total			189		562.15

*sloping roof is rated at 50%